

Rotalock® Components

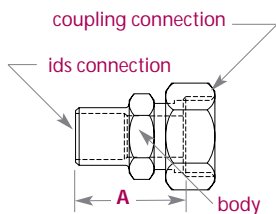

Connections		part number	Body	A (inches)
ids	coupling			
3/8	3/4-16	SA03	7/8 hex	1 9/32
1/2	1-14	SA04	7/8 hex	1 7/32
5/8	1-14	SA05	7/8 hex	1 9/32
7/8	1 1/4-12	SA07	1 1/8 hex	1 23/32
1 1/8	1 1/4-12	SA09	1 1/8 hex	1 31/32
1 3/8	1 3/4-12	SA11	1 3/4 hex	2 7/16

straight adapter

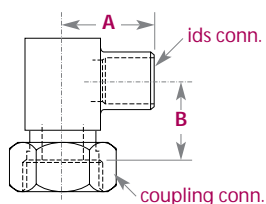

Connections		part number	A (inches)	B (inches)
ids	coupling			
3/8	3/4-16	AA03	1 5/16	1/2
1/2	1-14	AA04	1 3/32	17/32
5/8	1-14	AA05	1 3/32	19/32
7/8	1 1/4-12	AA07	1 9/16	5/8
1 1/8	1 1/4-12	AA09	1 13/16	1
1 3/8	1 3/4-12	AA11	2 3/16	1

angle adapter

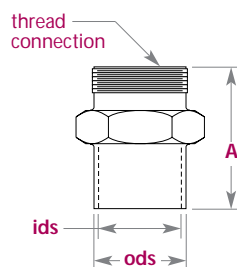

Connections			part number	A (inches)
ids	ods	thread		
3/8	1/2	3/4-16	BA03x06	1 5/16
3/8	1/2	1-14	BA03x08	1 5/16
1/2	5/8	1-14	BA04x08	1 5/16
5/8	7/8	1-14	BA05x08	1 5/16
5/8	7/8	1 1/4-12	BA05x10	1 9/16
7/8	1 1/8	1 1/4-12	BA07x10	1 9/16
1 1/8	1 3/8	1 1/4-12	BA09x10	1 9/16
1 1/8	1 3/8	1 3/4-12	BA09x14	1 11/16
1 3/8	1 5/8	1 3/4-12	BA11x14	1 11/16

brass adapter

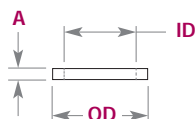

Dimensions (inches)			use with thread	part number
ID	OD	A		
7/16	9/16	1/16	3/4-16	TS-24590
5/8	3/4	1/16	1-14	TS-24591
7/8	1	1/16	1 1/4-12	TS-24592
1 3/8	1 1/2	1/16	1 3/4-12	TS-24593

teflon fiber seal



valve and component notes

Steel valves and adapters with ids connections are electroplated and can be silver soldered. The valve stem packing can withstand considerable heat, but should be kept as cool as possible. Valves should be slightly open while soldering.

Teflon seals should be installed only after all soldering is completed. A seal is furnished with each valve, adapter or connection supplied on a vessel. Order additional seals for replacement only.

Steel valves with flare connections are cadmium plated. The stem packing will not withstand soldering temperatures, and the valve body must be protected if soldering is done near the valve.